

Starling Stopper

Tools Needed: Phillips head screwdriver

Step 1). Align the hole at the top of the arch of the Starling Stopper to the hole that is used for the Tunnel Trap found above the entrance.

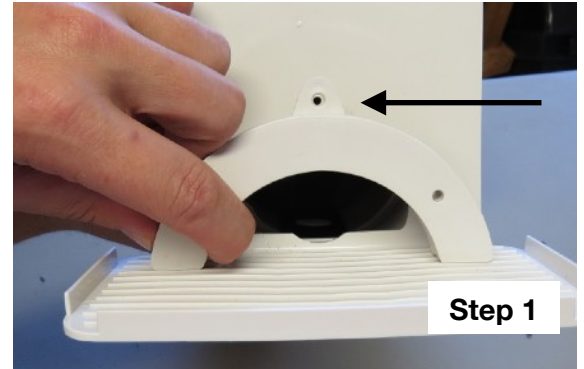

Step 2). Using one of the screws provided thread the screw into the the Starling Stopper tabbed hole then into the Troyer Tunnel.

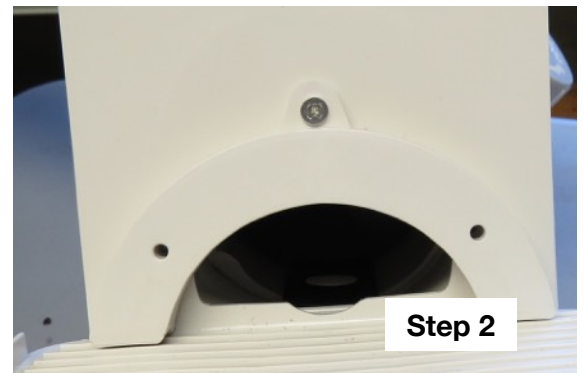

Step 3). It doesn't matter whether you do the left side or right side, simply take your screw, insert it into the hole found on the Stopper and using your screw driver insert the screw into the tunnel.



Step 4). Repeat step 3 on the opposite side. That's it. Please be sure to add pine needles to your gourds before hanging.

It is very important to monitor your gourds with the Starling Stoppers in place. As the Starling Stopper reduces the size of the entrance hole, and not all martins are the same size, it may stop the martin from entering the gourd. If this should happen, simply remove the screws and the Starling Stopper will come off.

We would appreciate your feed back on this product. Please call us or send us a note and let us know how the Starling Stopper worked for you.

